



# LAND AT HOLLINS HILL FARM

Charltons, Guisborough, TS12 3DF



**GSC GRAYS**  
PROPERTY • ESTATES • LAND



# LAND AT HOLLINS HILL FARM

CHARLTONS, GUISBOROUGH, TS12 3DF

Guisborough 3 miles, Saltburn-on-Sea 6 miles  
(Distances approximate)

A BLOCK OF PRODUCTIVE ARABLE LAND WITH GOOD ACCESS

About 69.39 acres (28.08 ha)  
FOR SALE AS A WHOLE OR IN LOTS



**GSC GRAYS**

PROPERTY • ESTATES • LAND

5 & 6 Bailey Court, Colburn Business Park,  
Richmond, North Yorkshire, DL9 4QL

Tel: 01748 829217

[www.gscgrays.co.uk](http://www.gscgrays.co.uk)

[richmond@gscgrays.co.uk](mailto:richmond@gscgrays.co.uk)

Offices also at:

Alnwick  
Tel: 01665 568310

Chester-le-Street  
Tel: 0191 303 9540

Barnard Castle  
Tel: 01833 637000

Driffield  
Tel: 01377 337180

Boroughbridge  
Tel: 01423 590500

Kirkby Lonsdale  
Tel: 01524 880320







### Description

The land at Hollins Hill Farm comprises approximately 69.39 acres of good quality, productive arable land, lying between about 140m and 150m above sea level with gently undulating topography. The land is bound by mature hedgerows and has good access from a private farm track or the public highway.

The soils are described by Soilscape England as base rich loam and clay which are slightly acid and may lie seasonally wet in places. It is predominantly suitable for arable and grassland production with an Agricultural Land Classification of predominantly Grade 3.

The land is currently farmed in-hand and is sown to spring barley (45.22 acres) and fallow (17.47 acres). A 5-year cropping schedule is available on request.

### Land Schedule

Field No	Arable (ha)	Grass (ha)	Woods (ha)	Other (ha)	Total (ha)	Total (ac)
4340			1.1		1.1	2.72
7842				0.02	0.02	0.05
7717	5.23				5.23	12.92
5397	7.07				7.07	17.47
9407				0.04	0.04	0.10
9102	4.78				4.78	11.81
4699			1.55		1.55	3.83
6794	5.11				5.11	12.63
7888	3.18				3.18	7.86
<b>TOTAL</b>	<b>25.37</b>	<b>0</b>	<b>2.65</b>	<b>0.06</b>	<b>28.08</b>	<b>69.39</b>





#### **Restrictive Covenant**

We understand that the land is sold subject to a historic restrictive covenant that prohibits the “erection of any buildings on the land other than a single dwelling or pair of agricultural cottages with or without farm buildings without the written consent of the Transferor”.

#### **Basic Payment Scheme**

Any future de-linked payments will be retained by the Vendors.

#### **Designations**

The property lies within the North York Moors National Park.

#### **Nitrate Vulnerable Zone**

The land is not located within a Nitrate Vulnerable Zone (NVZ).

#### **Tenure**

The land is to be sold freehold with vacant possession.

#### **Sporting Rights**

These are included in the sale in so far as they are owned.

#### **Mineral Rights**

The mineral rights are excepted from the sale with provision for compensation in the event of any damage caused by their workings.

#### **Wayleaves, Easements and Rights Of Way**

The property is sold subject to and with the benefit of all existing rights, including rights of way, whether public or private, light, drainage, water and electricity supplies and all other rights obligations, easements, quasi-easements and all wayleaves and covenants, whether disclosed or not.

#### **Services**

There are no public services connected to the land.

#### **Boundaries**

The Vendor will only sell such interests as they have in the boundary hedges and fences. Responsibility for the fences will be as indicated by the ‘T’ marks on the transfer plan.

#### **VAT**

Any guide prices quoted or discussed are exclusive of VAT. Should any part of the sale or any rights attached to it become chargeable items for the purpose of VAT then this will be payable by the purchaser. No option to tax has been made.

#### **Method of Sale**

The land is offered for sale by private treaty. All potential purchasers are advised to register their interest with the Selling Agents so that they can be advised as to how the sale will be concluded.

#### **Ingoing Valuation**

In addition to the purchase price, the purchaser(s) will take over and pay for all growing crops, cultivations, stocks and stores at valuation. Payment is to be made on completion at a figure assessed by the Vendor’s valuer based on CAAV or contractor rates where applicable and invoice costs of seeds, fertilizers and sprays applied plus enhancement value if applicable.

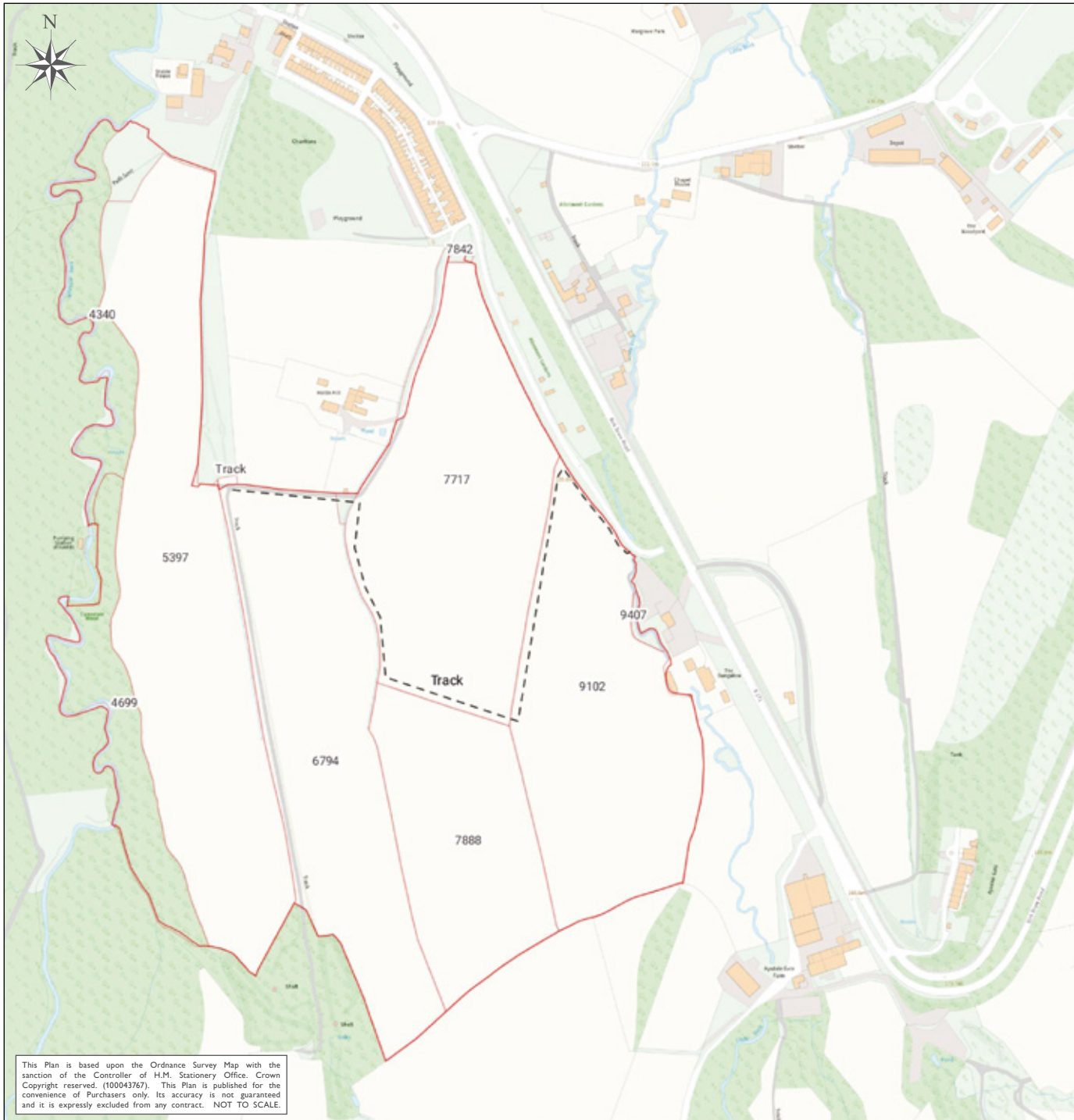

This Plan is based upon the Ordnance Survey Map with the sanction of the Controller of H.M. Stationery Office. Crown Copyright reserved. (100043767). This Plan is published for the convenience of Purchasers only. Its accuracy is not guaranteed and it is expressly excluded from any contract. NOT TO SCALE.

### Directions

From Stokesley, head South West on the A173 and A171 towards Guisborough. Proceed through Chaltons village onto Birk Brow Road. The land is located either side of the road and signposted by a GSC Grays Sale Board.

what3words: syndicate.hospitals.gosh

### Viewing & Health and Safety

By appointment through the Selling Agents by calling: 01748 829203.

Please take care when viewing the property particularly as this is a working farm. For your own personal safety, you should remain as vigilant as possible particularly around livestock or buildings.

### Conditions of Sale Purchase Price

Upon exchange of contracts a non-returnable deposit of 10% of the purchase price shall be paid. The balance will fall due for payment on completion at a date to be agreed and whether entry is taken or not with interest accruing at the rate of 5% above the Bank of England base rate.

### Disputes

Should any discrepancy arise within these particulars of sale or the interpretation of them, the question shall be referred to the arbitration of the Selling Agents whose decision acting as experts will be final.

### Plans, Areas and Schedules

These are based on the Ordnance Survey and Rural Land Register and are there for reference only. They have been carefully checked by the selling agents and the purchaser shall be deemed to have satisfied himself as to the description of the property and any error or mis-statement shall not annul the sale nor entitle either party to compensation in respect thereof.



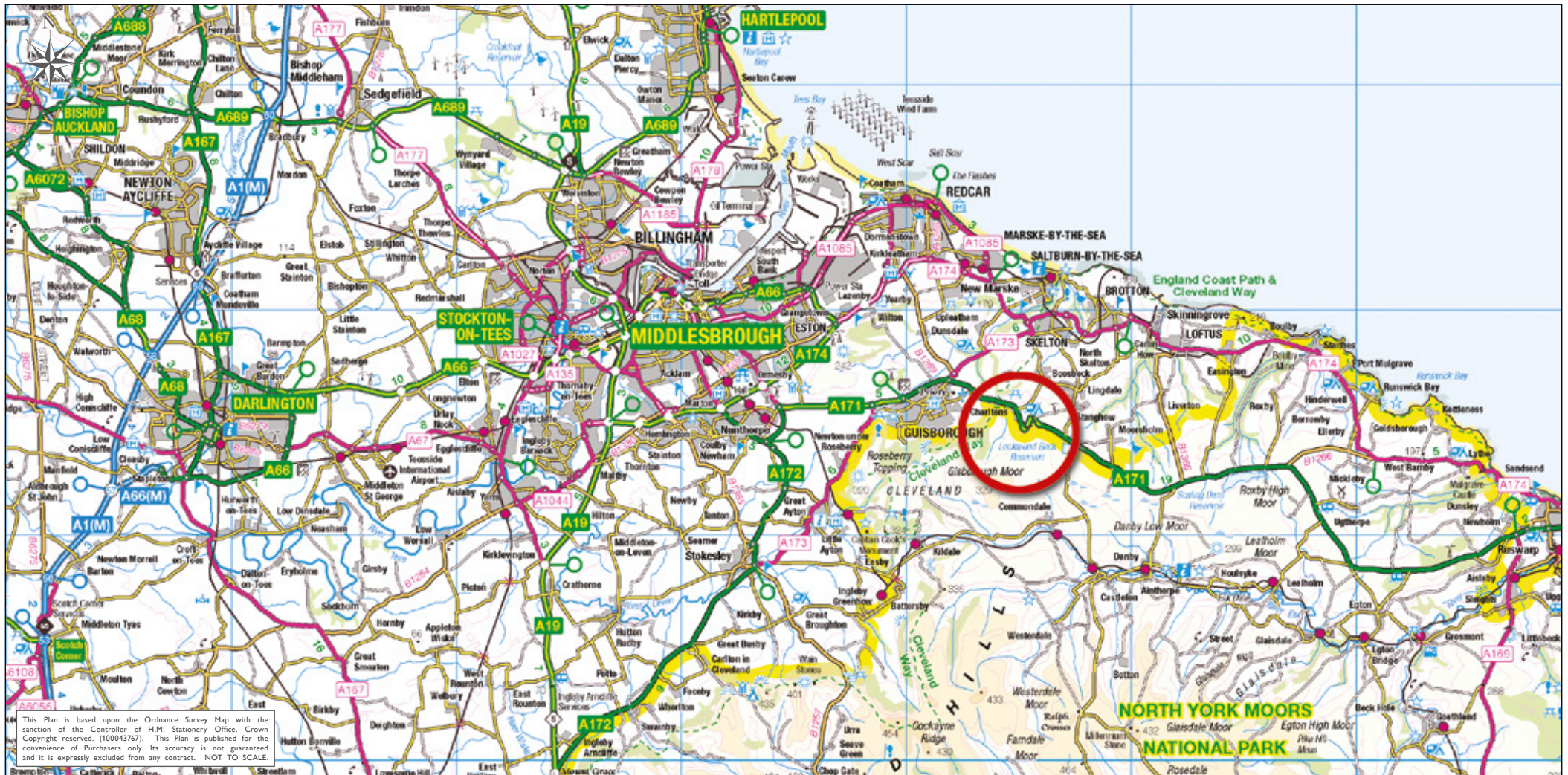

This Plan is based upon the Ordnance Survey Map with the sanction of the Controller of H.M. Stationery Office. Crown Copyright reserved. (100043767). This Plan is published for the convenience of Purchasers only. Its accuracy is not guaranteed and it is expressly excluded from any contract. NOT TO SCALE.

**DISCLAIMER NOTICE:**

PLEASE READ: GSC Grays gives notice to anyone who may read these particulars as follows:

1. These particulars, including any plan, are a general guide only and do not form any part of any offer or contract.
2. All descriptions, including photographs, dimensions and other details are given in good faith but do not amount to our presentation or warranty. This should not be relied upon as statements of facts and anyone interested must satisfy themselves as to their corrections by inspection or otherwise.
3. Neither GSC Grays nor the vendors accept responsibility for any error that these particulars may contain however caused.
4. Any plan is for guidance only and is not drawn to scale. All dimensions, shapes, and compass bearings are approximate and you should not rely on them without checking them first.
5. Nothing in these particulars shall be deemed to be a statement that the property is in good condition, repair or otherwise nor that any services or facilities are in good working order.
6. Please discuss with us any aspects that are important to you prior to travelling to the property.

Particulars written: May 2023 and July 2024  
 Photographs taken: May 2023 and July 2024